



SERVICE MANUAL FOR CIRCLE DYNAMICS INC.

DPT4 – DOYLE PAIL MOUNT MIXER DRIVE WITH (SOLID w/ 3/4” INLET STUBS) LID

WARNING

This product is intended for use in an industrial mix room environment. It is the user's responsibility to ensure that all forms of external energy are removed from the product prior to servicing to eliminate the risk of being injured by rotating parts during service.

FAILURE MODES

This product is only to be used in accordance with Circle Dynamics instructions for use and applications. Any other application may result in serious injury.



INSTALLATION (Refer to Fig. 1)

Fig. 1 (DPT2 Lid shown)

- Remove *setscrews* (3) from *drive coupling* (2). Install Loctite 242 (loctite blue) onto *setscrews* (3)
- Install *setscrews* (3) into *drive coupling* (2).
- Align *setscrew* (3) in *drive coupling* (2) with flat on air motor.
- Slide *drive coupling* (2) onto motor drive shaft. Tighten *setscrew* (3) onto motor drive shaft.
- Align mounting holes of *DPT2 housing* (1) over the mounting holes of the *DPT2 lid* (7).
- Install *lock washer* (9) and *washer* (8) onto *bolt* (10) and install *bolt* (10) through the mounting holes of the *DPT2 lid* (7) and tighten into *DPT2 housing* (1)
- Install *DPT2 shaft and prop* (4) through the shaft hole of the *DPT2 lid* (7) and into the *Drive coupling* (2). Align *set screw* (3) with the flat of the shaft. Tighten *setscrew* (3) onto *DPT2 shaft and prop* (4).

Connect air supply to appropriate port and adjust flow control to set speed.

REBUILD INSTRUCTIONS FOR CIRCLE DYNAMICS DPT DRIVE UNIT

DISASSEMBLY

- 1) Disconnect any energy source and remove motor / DPT2 assembly from the pail.
- 2) Loosen off *setscrew* (3) from *shaft and prop* (4). Remove *shaft and prop* (4).
- 3) Remove *bolt* (10) *washer* (8) and *lock washer* (9) from the assembly and remove *DTP2 lid* (7)
- 4) Remove *bolt* (6) and *washer* (5) from the *DTP2 housing* (2). Pull housing away from the motor.
- 5) Loosen off *set screw* (3) from air motor. Pull off Drive coupling (2).



Fig. 2 (DPT2 Lid shown)

ASSEMBLY (refer to fig.3)

1. Install Loctite 242 (Loctite blue) onto *setscrews* (3)
2. Install *setscrews* (3) into *drive coupling* (2).
3. Align *setscrew* (3) in *drive coupling* (2) with flat on air motor.
4. Slide *drive coupling* (2) onto motor drive shaft. Tighten *setscrew* (3) onto motor drive shaft.
5. Slide *DPT2 housing* (1) onto motor.

NOTE: Be sure to have the orientation of the housing correct → none threaded mounting holes against the lower motor housing).

6. Rotate the drive housing until the three mounting holes (none threaded) line up with the air motors mounting holes.
7. Install *mounting bolts* (6) and *washers* (5) and tighten securely.
8. Align mounting holes (threaded) of *DPT2 housing* (1) over the mounting holes of the *DPT2 lid* (7).
9. Install *lock washer* (9) and *washer* (8) onto *bolt* (10) and install through the mounting holes of the *DPT2 lid* (7) and tighten into *DPT2 housing* (1)
10. Install *DPT2 shaft and prop* (4) through the shaft hole of the *DPT2 lid* (7) and into the *Drive coupling* (2). Tighten *setscrew* (3) onto *DPT2 shaft* (4).

Refer to installation instructions for assembly to Air Motor.

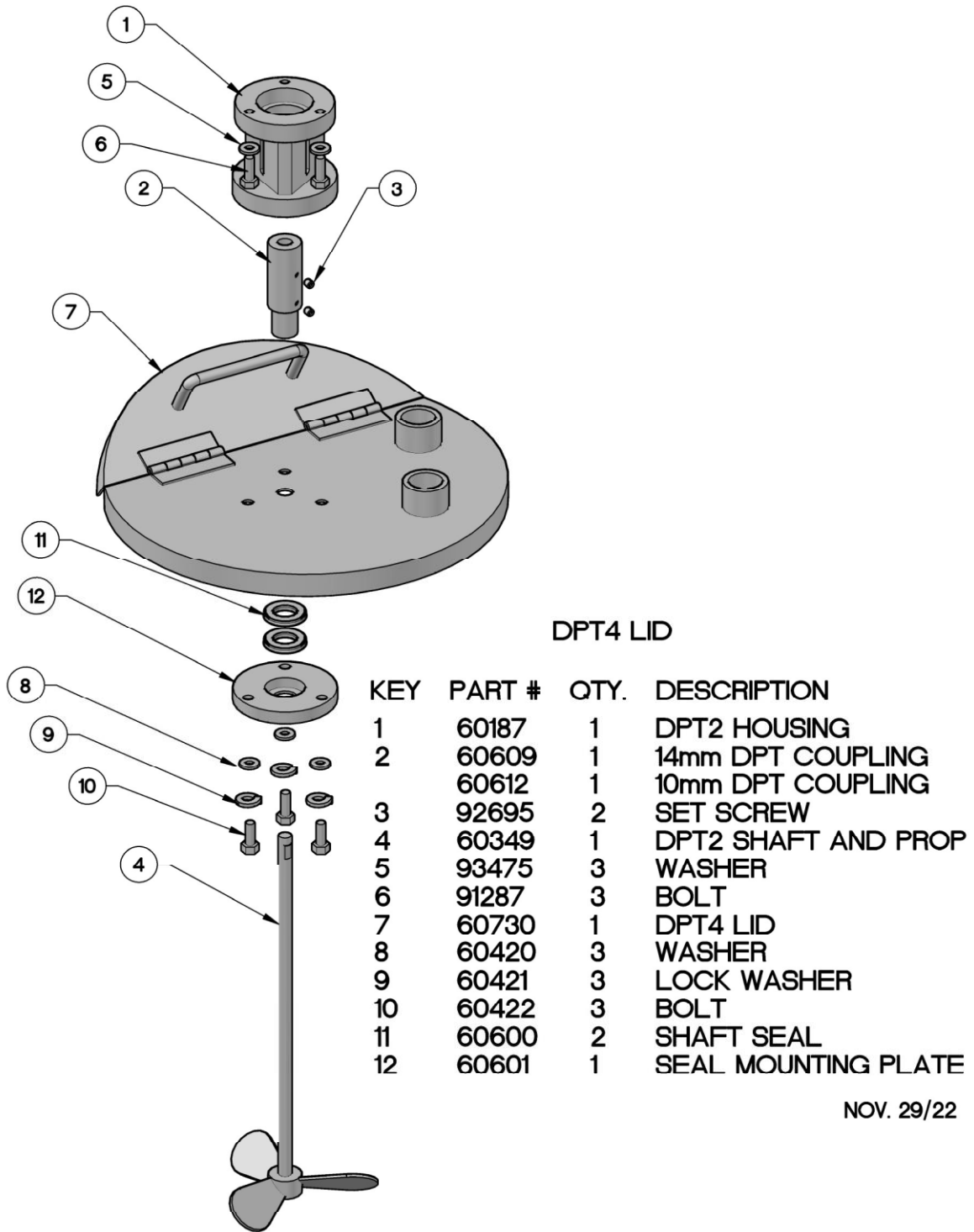

Fig. 3

TECHNICAL DATA

Maximum Speed: 1100 RPM

Housing: Anodized Aluminum

Shaft and prop: 304 S.S.

Lid: 304 S.S.

Drive coupling: 303 S.S.

THE CIRCLE DYNAMICS INC. WARRANTY AND DISCLAIMERS

Items sold by Circle Dynamics Inc. and or all Doyle Products are warranted to be free from defects in material and workmanship for a period of one year from the date of purchase, provided said items are used according to Doyle Products said usages. Circle Dynamics Inc. liability is limited to the repair of, refund of purchase price paid for, or replacement in kind of at the sole option of Circle Dynamics Inc., any items proved defective, provided the allegedly defective items are returned to Circle Dynamics Inc. prepaid. There are no other warranties, expressed or implied, except as stated herein. There are no implied warranties of merchantability of fitness for a particular purpose, which are damages, if the possibility of such incidental or consequential damages has been made know to Circle Dynamics Inc., or is the direct result of a failure of a Doyle Product. Circle Dynamics Inc. reserves the right to discontinue the manufacture of any product or change product materials, design or specifications without notice.

<p>Patent Pending Copyright 2011 Circle Dynamics Inc. All rights reserved. Models and specifications subject to change without notice.</p>	<div data-bbox="938 1346 1455 1539" data-label="Image"> </div> <p>Circle Dynamics Inc. 171 A Rink Street, Suite 150 Peterborough, Ontario, Canada K9J 2J6 Tel: 1-705-768-3338 Fax: 1-705-740-1975 Email: jdoyle@circledynamicsinc.com Web: www.circledynamicsinc.com</p>
--	--